



Corporate Lift proudly presents:
1998 Citation Bravo



Airframe

Total Time: 7800 hrs.
(as of 04/01/2022)
Total Landings: 7890

Aircraft Summary

While the Citation Bravo was built on the basic Citation II airframe, Textron Aviation strived on improving the old airframe; this aircraft was powered by Pratt & Whitney Canada PW530A engines. The main landing gear was replaced by the smoother-riding trailing link configuration adopted by other members of the Citation line, and the standard avionics suite was updated to the Honeywell Primus 1000 glass cockpit.

Engines

En. # 1	En. # 2
Pratt & Whitney	Pratt & Whitney
PW530A	PW530A
TT: 7575.3 hrs.	TT: 7575.3 hrs.
Cycles: 7687	Cycles: 7687

Aircraft Highlights

- Honeywell Primus 1000 glass cockpit.
- 2022 Paint
- New carpets (2022)
- Operated Part 135
- ADSB-Out
- CAMP Maintenance monitoring



This Citation Bravo is equipped with a Honeywell Primus 1000 glass cockpit

- Honeywell Primus 1000
- 3 Tube EFIS
- Honeywell CD-820 Control Display Unit
- Dual Honeywell AZ-850 Air Data Computers
- Comm : Dual Ky-196B
- Nav : Dual KN-53 w/ FM Immunity
- ADF : KR - 87
- Transponder : Dual KT-70
- FMS : GNS-XLS
- Radar : Honeywell Primus 660 (color)
- EGPWS : Mark VI
- HF – Provisions
- Fairchild FA2100 (120 min) CVR
- Honeywell TPU-67A TCAS-II w/change 7

Additional Features and Equipment

- ADSB Out
- TR's
- EGPWS
- RVSM
- GNS-XLS
- BEW 9,135 LBS
- Tail Flood Light
- AIRTEX ELT

Range

- Normal Range: 1290 nm
- Max Range: 1720 nm
- Service Ceiling: 43000 ft

Distances

- Balanced Field Length: 4160 ft
- Landing Distance: 4295 ft

Weights

- Max T/O Weight: 14800 Lb
- Max Landing Weight: 13500 Lb
- Operating Weight: 9375 Lb
- Empty Weight: 8059 Lb
- Fuel Capacity: 4824 Lb
- Payload W/Full Fuel: 801 Lb
- Max Payload: 1925 Lb





Interior

2022 New Carpet.

- Maple wood scheme with tan leather over grey "tuxedo" carpet.
- 7 (seven) passenger configuration featuring 1 LH aft facing club chair followed by a double club configuration with executive service tables in the forward cabin, and two forward facing club chairs in the aft cabin.
- Belted flushing toilet in the enclosed Aft Lavatory.
- Forward LH refreshment center and RH utility rack and drawers.
- Plating has a dark old-bronze finish.
- Overall, the aircraft interior shows very well and no signs of wear and tear. 8/10

Materials and Condition



Original **Cessna/Textron Grey Leather** seats in good condition, with just a few wear marks mainly on the arm rests.



Brand new, 2022 **Tuxedo Grey** carpet



Cherry Wood Flat Finish veneer on refreshment center, forward drawers, with very few (mostly unnoticeable) scratches.

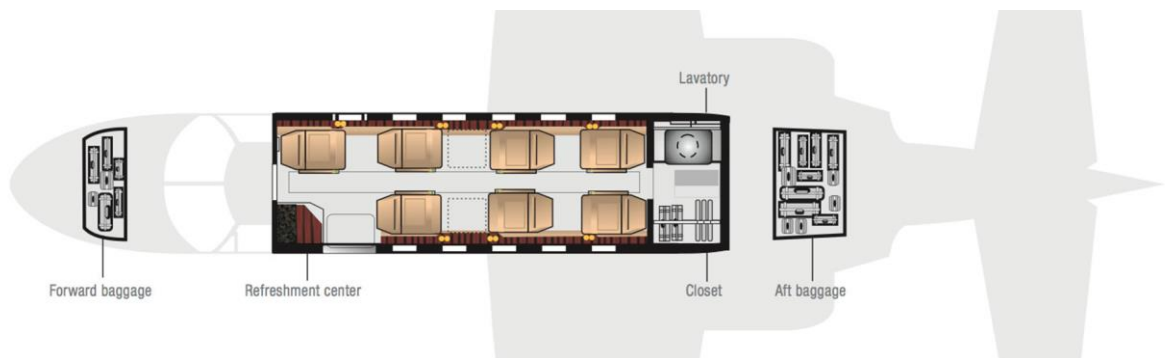

Other Interior Highlights

- Airshow 400 Cabin Management System with DVD and video player
- 110V AC Outlet



Exterior

2022 Paint:

- All over **Base Matterhorn White** with Double-to-Triple Wave Pattern **Stripes on a Sable Metallic and Platinum Silver** Scheme.
- Highlight **Stripe in Old Gold** over waves.
- Paint is in brand new condition.



PPG SABLE METALLIC IM965



PPG PLATINUM SILVER IM911



PPG MATTERHORN WHITE I1050

Rendering Colors May Vary From Actual Paint Colors

Maintenance Status

- | | | |
|------------------|---------------|----------------|
| • Phase 1 thru 4 | c/w 07/2021 | next 07/2023 |
| • Phase 5 | c/w 04/2021 | next 04/2024 |
| • Eng. OVH | c/w 4,257 hrs | next 8,257 hrs |



CORPORATE LIFT

JET TRADING

CONTACT US:

Bill Kaczor

+1 561 855 1645 | +1 561 245 1133

e-mail: bill@corporatelift.com | www.corporatelift.com